

Butler -  
Luzerne.

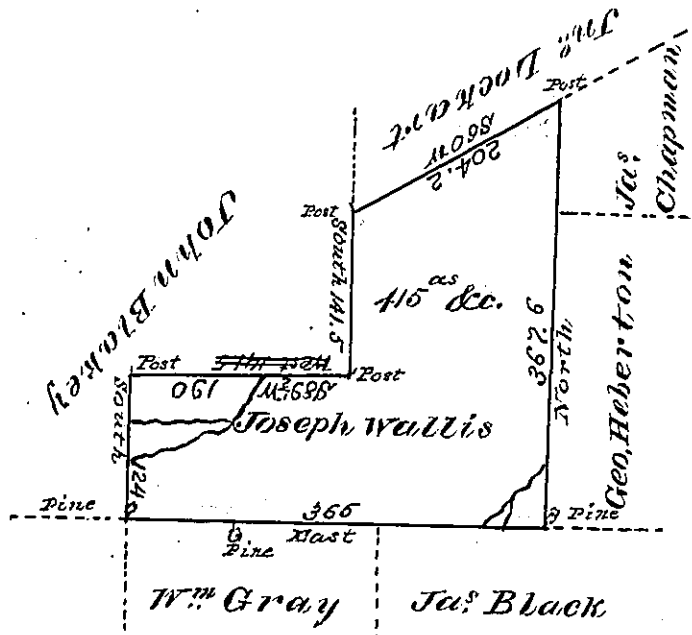

A draft of a tract of land called, situate  
 joining Land Surv<sup>d</sup> for W<sup>m</sup> Gray and others in the  
 County of Northumb<sup>d</sup>. containing four hun —  
 and fifteen acres & allow<sup>s</sup>. surveyed for Joseph  
 Wallis the 5<sup>th</sup> day of Sep<sup>r</sup> 1793 by virtue of a warrant  
 dated the 13<sup>th</sup> day of June 1793.

To  
 Daniel Brodhead Esq<sup>r</sup> }  
 Surv<sup>r</sup> Gen<sup>l</sup> }

by W<sup>m</sup> Gray S. S.

IN TESTIMONY that the above is a copy of the original remaining on file in the  
 Department of Internal Affairs of Pennsylvania, made con-  
 formably to an Act of Assembly approved the 16th day of  
 February, 1833, I have hereunto set my Hand and caused  
 the Seal of said Department to be affixed at Harrisburg, this

Nineteenth — day of — July — 1876

*Wm Mcandless*

Secretary of Internal Affairs